



Aluminum Clad Wood – Installation Instructions

New Construction Installation Instructions

1. Preparations: All framing members must conform to present industry standards. Recommend using a pre-stain on the interior wood pieces. Be sure to remove all staples that secure the nailing fin to the frame.

2. Set window in rough opening from outside with nailing fin overlapping exterior sheathing. Provide a continuous bead of sealant between the nailing fin and exterior sheathing. Press the fin into the sealant before anchoring. Center and level the window within the rough opening using shims where necessary. As you shim the window the nailing fin should be secured with #10 x 2" long pan head wood screws with #10 washers, starting 3" in from all corners and 8" on center maximum spacing.

3. Install (wood or plastic) shims to center the window between the head and the sill (**Figure 1**).

4. Plumb side jamb of window, be sure to check both side-to-side and front-to-back alignment. Shim if necessary. Shim spaces to be no more than 3/8" per side.

5. First, remove interior wood stop. Secure window unit from the inside with 10D or 3" long finishing nails through wood frame, shim and 2 x 4 framing after removing wood stop (**Figure 2**). Secure wood stop with 1" long brad nails 1" from each corner and spaced no more than 8" on center. All finishing nails should be driven as close to perpendicular to the frame as tools will allow. Finishing nails can be countersunk and puttied over before optional staining of wood.

Note: Securement of the wood stop from the factory should not be solely relied upon for anchorage of the window unit to the framing members.

6. Install 9" flashing strips over the nailing fins as shown in **Figure 3**. Apply underlayment (such as building paper) in a shingled (overlapping) pattern or follow industry standards for window flashing.

7. After exterior siding or brick is applied, caulk around perimeter of window unit. (When brick veneer is used as exterior finish, adequate clearance must be left for caulking between window sill and masonry. This will prevent damage and bowing of sill caused by shrinkage and settling of structural lumber.)

Sizing Chart	
* Nominal Width or Height	** Rough Opening Required
16"	18 1/2"
24"	26 1/4"
32"	34"
40"	41 11/16"
48"	49 3/8"
56"	57 3/8"
64"	64 15/16"
72"	72 11/16"
80"	80 1/2"

* Based on 8" x 8" nominal sized glass block.
 ** Rough Opening = Actual Size + 3/4".

Finishing Accessory

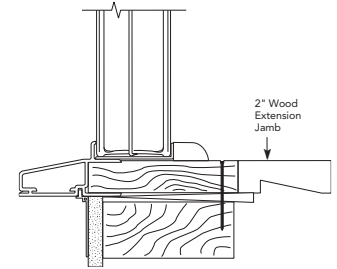

Sill Detail for Optional 2 x 6 Construction

Installation & Cleaning Recommendations

- Use a detergent-water solution and soft rag or brush to remove dust, dirt, smoke film, soot or salt spray from aluminum frame surfaces.
- For glass surfaces, follow common window-cleaning procedures using warm soapy water or a branded glass cleaning product.
- Protect LightWise® Windows from power washing and acid cleaning of surrounding walls.

Safety Glazing Test	
ANSI Z 97.1	Passed 12", 18" and 48" drops
CPSC-16-CFR 1201	Passed 48" drop

AAMA/WDMA/CSA 101/I.S. 2/A440-08 & 05		
AAMA Designation	Optional Water Test	Air Test
FW-R 60 (40 x 80)	440 Pa (9.0 PSF)	75 Pa (1.6 PSF)
FW-R 60 (56 x 64)	440 Pa (9.0 PSF)	75 Pa (1.6 PSF)

The information contained herein is accurate and reliable to the best of our knowledge. But, because Pittsburgh Corning Corporation has no control over installation workmanship, accessory materials or conditions of application, NO EXPRESS OR IMPLIED WARRANTY OF ANY KIND, INCLUDING THOSE OF MERCHANTABILITY OR FITNESS FOR A PARTICULAR PURPOSE, IS MADE as to the performance of an installation containing Pittsburgh Corning products. In no event shall Pittsburgh Corning be liable for any damages arising because of product failure, whether incidental, special, consequential or punitive, regardless of the theory of liability upon which any such damages are claimed. Pittsburgh Corning Corporation provides written warranties for many of its products, and such warranties take precedence over the statements contained herein.



PITTSBURGH CORNING™

PITTSBURGH CORNING CORPORATION
 800 Presque Isle Drive
 Pittsburgh, PA 15239
 724-327-6100

pittsburghcorning.com

MADE IN AMERICA

LightWise® logo is a registered trademark owned and protected by Pittsburgh Corning Corporation, Pittsburgh, PA 15239

©2011 Pittsburgh Corning Corporation

Printed in U.S.A.

LWW-200 (AC) .5M 3/11

